

Job Name _____
 Job Location _____
 Engineer _____
 Approval _____

Contractor _____
 Approval _____
 Contractor's P.O. No. _____
 Representative _____

GOVERNOR^{10 PSIG} OVER PRESSURE DEVICE (OPD) MODEL

Gas Pressure Regulators

Sizes 1/2" – 2" NPT and 2 1/2" - 4" ANSI 150 Flanged

The GOVERNOR family of regulators are ideal for a wide range of residential through large industrial applications. The materials and soft parts used in the construction of the GOVERNOR regulators make them suitable for use with natural gas, LPG, Propane air and other non-corrosive gases. **NOTE: Do not use the standard Governor 1/2" - 1" NPT on High efficiency equipment!**

All GOVERNOR regulators are equipped with balanced valve design for improved high outlet pressure accuracy regardless of Inlet pressure variation. The double diaphragm with integral vent limiter provides added security. The external vent limiter reduces piping costs and the need for costly vent piping for indoor installations and complies with CSA guidelines.* The number of high capacities and regulator options sometimes eliminates the need for separate units and significantly reduces installation costs.

The following Features and Specifications that give you Safe, Reliable and High Performance.

SPECIFICATIONS

- Internal vent limiter: non removable, for indoor and outdoor installations in any position.
- The OPD Governor is a 2 stage design where the monitor first regulator cuts to 70% more than the worker control regulator pressure. From the factory the monitor is set at 12 w.c. and the worker is set at 8" w.c..
- The Governor is CSA Certified external vent limiter option for indoor installations.* Can be installed in any position.
- The Governor incorporates a double molded diaphragm added safety and greater reliability of service.
- The Governor incorporates a balanced valve design gives you for increase capacity, high 500 to 1 turndown and stable regulation from low to high flows.
- The Governor incorporates a Nitrile valve and a machined orifice that provides complete lockup in absence of gas low, 100% bubble tight shutoff.
- Approved ANSI Z21.80A-2019 / CSA 6.22A-2019 Class II for outlet pressures from 2" W.C. to 1 PSIG certified.
- Approved ANSI Z21.18B-2019 / CSA 6.3B-2019 for outlet pressure up to 10 PSIG certified
- The Governor incorporates an inlet filter included in all models.
- Temperature Range: -40°F to 150°F
- Inlet Pressure Range: 3 to 10 PSIG
- Max. inlet Pressure: CSA rated and For Non CSA - 10 PSIG
- Maximum Emergency Inlet Exposure Pressure: 80 PSIG
- Suitable for Indoor or Outdoor Installation***
- Connections: 1/2"-1" NPT and 1 1/4" to 2" NPT 2 1/2" to 4" Flanged
- Suitable for use with Natural Gas, LPG, and other non-corrosive, clean gas.
- Vent connections 1/4 NPT for 1/2 - 1" and 1/2" NPT and 1 1/4" - 4" ANSI Flanged

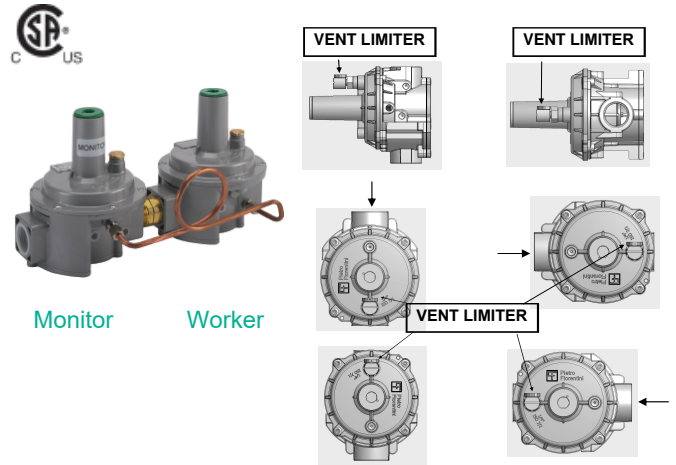

Note: Multi vent limiter position approved but flat top must face up.

Basic Design Feature

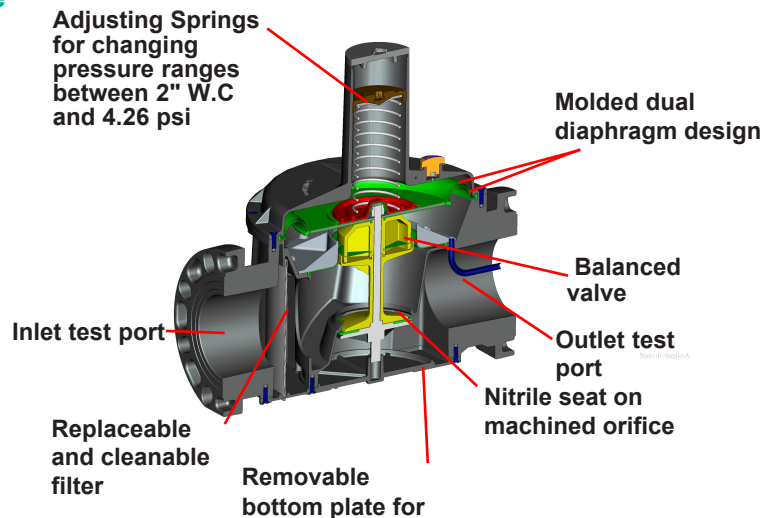

MATERIALS

- Body & Cover: Aluminum Alloy
- External Coatings: Polyurethane paint upon request
- Diaphragm, O Rings & Valve: Nitrile Rubber
- Diaphragm Pan: Aluminized Steel

**As Approved by Local Codes and Standards

***Brass vent limiter must be removed for outdoor installation

OVER PRESSURE DEVICE (OPD) MODEL

CAPACITY IN CFH FOR .60 SPECIFIC GRAVITY GAS WITH FILTER (CAPACITY WITHOUT FILTER IN BRACKETS)

Outlet Pressure Set Point		Operating Inlet Pressure		
		3 PSIG	5 PSIG	10 PSIG
31051 DC ½"	8" W.C.	785 (923)	785 (923)	785 (923)
	11" W.C.	788 (927)	788 (927)	788 (927)
	14" W.C.	790 (930)	790 (930)	790 (930)
31052 DC ¾"	8" W.C.	946 (1,154)	946 (1,154)	946 (1,154)
	11" W.C.	950 (1,158)	950 (1,158)	950 (1,158)
	14" W.C.	953 (1,163)	953 (1,163)	953 (1,163)
31053 DC 1"	8" W.C.	1,270 (1,500)	1,270 (1,500)	1,270 (1,500)
	11" W.C.	1,274 (1,506)	1,274 (1,506)	1,274 (1,506)
	14" W.C.	1,279 (1,512)	1,279 (1,512)	1,279 (1,512)
31150 DC ½" High Capacity	8" W.C.	1,731 (2,193)	1,731 (2,193)	1,731 (2,193)
	11" W.C.	1,738 (2,201)	1,738 (2,201)	1,738 (2,201)
	14" W.C.	1,744 (2,209)	1,744 (2,209)	1,744 (2,209)
31151 DC ¾" High Capacity	8" W.C.	2,020 (2,771)	2,020 (2,771)	2,020 (2,771)
	11" W.C.	2,028 (2,781)	2,028 (2,781)	2,028 (2,781)
	14" W.C.	2,035 (2,791)	2,035 (2,791)	2,035 (2,791)
31152 DC 1" High Capacity	8" W.C.	2,540 (3,290)	2,540 (3,290)	2,540 (3,290)
	11" W.C.	2,549 (3,302)	2,549 (3,302)	2,549 (3,302)
	14" W.C.	2,558 (3,314)	2,558 (3,314)	2,558 (3,314)
31153 DC 1¼"	8" W.C.	5,311 (7,851)	5,311 (7,851)	5,311 (7,851)
	11" W.C.	5,330 (7,880)	5,330 (7,880)	5,330 (7,880)
	14" W.C.	5,350 (7,909)	5,350 (7,909)	5,350 (7,909)
31154 DC 1½"	8" W.C.	6,581 (8,197)	6,581 (8,197)	6,581 (8,197)
	11" W.C.	6,605 (8,228)	6,605 (8,228)	6,605 (8,228)
	14" W.C.	6,629 (8,258)	6,629 (8,258)	6,629 (8,258)
31155 DC 2"	8" W.C.	13,278 (15,009)	13,278 (15,009)	13,278 (15,009)
	11" W.C.	13,327 (15,065)	13,327 (15,065)	13,327 (15,065)
	14" W.C.	13,375 (15,120)	13,375 (15,120)	13,375 (15,120)
31156/F DC 2½"	8" W.C.	16,741 (19,051)	16,741 (19,051)	16,741 (19,051)
	11" W.C.	16,803 (19,121)	16,803 (19,121)	16,803 (19,121)
	14" W.C.	16,865 (19,191)	16,865 (19,191)	16,865 (19,191)
31157/F DC 3"	8" W.C.	18,473 (23,092)	18,473 (23,092)	18,473 (23,092)
	11" W.C.	18,542 (23,177)	18,542 (23,177)	18,542 (23,177)
	14" W.C.	18,610 (23,262)	18,610 (23,262)	18,610 (23,262)
31158/F DC 4"	8" W.C.	32,906 (40,411)	32,906 (40,411)	32,906 (40,411)
	11" W.C.	32,027 (40,560)	32,027 (40,560)	32,027 (40,560)
	14" W.C.	33,149 (40,709)	33,149 (40,709)	33,149 (40,709)

OUTLET SPRING RANGE *Spring is CSA outlet pressure certified

- Green 2" W.C. to 5.1" W.C.*
- Red 2.75" W.C. to 7.87" W.C.*
- Black 6" W.C. to 14" W.C.*
- Yellow 9.8" W.C. to 27.5" W.C.
- Violet 23.6" W.C. to 59" W.C.
- Orange 55" W.C. to 118" W.C.

***Brass vent limiter must be removed for outdoor installation

OVER PRESSURE DEVICE OPD MODEL DIMENSIONS

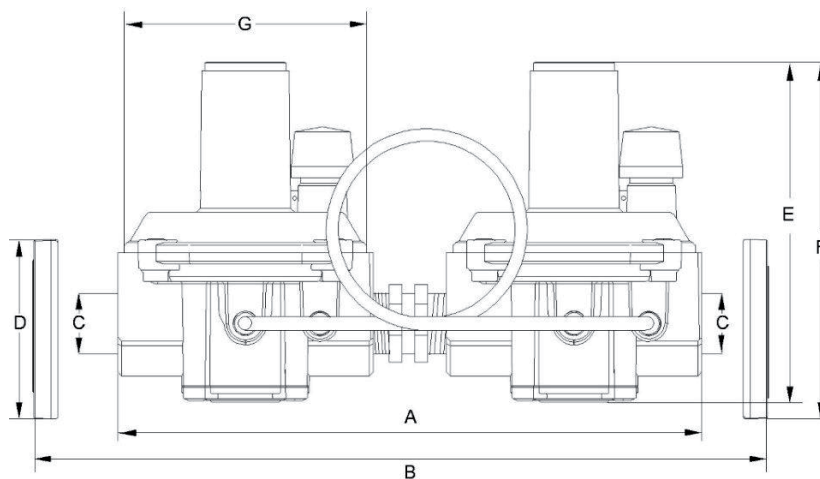

Model	Size	A	B	C	D	E	F	G*	Weight (Lbs)
PF400D	3/8 NPT	8.40	-	3/8	-	3.42	-	3.10	1.18
PF400D	1/2" NPT	8.50	-	1/2	-	3.42	-	3.10	1.20
31051	1/2" NPT	8.46	-	1/2	-	5.59	-	3.78	3.25
31052	3/4" NPT	8.46	-	3/4	-	5.59	-	3.78	3.25
31053	1" NPT	8.46	-	1	-	5.59	-	3.78	3.25
31150	1/2" NPT	10.10	-	1/2	-	6.89	-	4.49	5.75
31151	3/4" NPT	10.10	-	3/4	-	6.89	-	4.49	5.75
31152	1" NPT	10.10	-	1	-	6.89	-	4.49	5.75
31153	1 1/4" NPT	16.69	-	1 1/4	-	10	-	7.56	15.5
31154	1 1/2" NPT	16.69	-	1 1/2	-	10	-	7.56	15.5
31155	2" NPT	19.88	-	2	-	12.44	13.74	7.56	25
31156/F	2 1/2" FLANGED	-	33.93	3	ANSI 150	-	17.09	12.52	56
31157/F	3" FLANGED	-	33.93	3	ANSI 150	-	17.09	12.52	56
31158/F	4" FLANGED	-	33.93	4	ANSI 150	-	19.76	12.52	56

* (G) Dimensions is the width of the regulator



Pietro Fiorentini product specifications in U.S. are provided for reference only. For precise application assistance, please contact Pietro Fiorentini Technical Service or your local distributor. Pietro Fiorentini reserves the right to change or modify product design, construction, specifications, or materials without prior notice and without incurring any obligation to make such changes and modifications on Pietro Fiorentini products previously or subsequently sold.

Pietro Fiorentini USA,
Inc 606 Park Drive
Weirton, WV 26062 Ph.:
1-800-554-1036
www.gasinside.com

2020 Pietro Fiorentini USA, Inc